

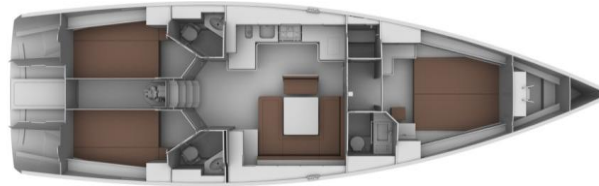

CRUISER 45

Length Overall 14.27M
Length of Hull - 13.60M
Length Waterline 12.74M
Beam Overall 4.35M
Draught Standard - 2.10M
Draught Option shallow - 1.73M
Displacement - 12,600KG approx
Ballast - 3,490KG approx (cast iron)
Engine (Volvo Penta D2-55) - 39Kw/53HP
Water Tank - 360L
Fuel Tank - 210L
Cabins - 3 (4 option)
Standard Mainsail - 60 sqm approx
Standard Jib (106%) - 47 sqm approx
Height in Saloon - 2.06M
Mast height above waterline - 20.75M



3 Cabin layout



4 Cabin layout

Hull & Deck

Hand-laid fiberglass, solid below the waterline
 Kevlar reinforced bow sections
 Side deck and coach roof with non-skid
 Stainless steel bow fitting with anchor roller
 Bow sprit for Gennaker/code zero
 Stainless steel bow pulpit
 Stainless steel double pushpit
 Rail openings both sides
 Double lifelines
 Six aluminum mooring cleats
 Two Lewmar self-tailing halyard winches
 Two Lewmar self-tailing Genoa winches
 Twin mainsheet system
 Two winch handles
 Sheets and halyards led to cockpit clutches
 Self-draining anchor locker
 Storage locker under cockpit floor
 Two cockpit lockers
 Large storage locker on foredeck
 Self-draining gas locker
 Stainless steel swim boarding ladder
 Deck vent
 Manual bilge pump
 Wooden cockpit table with ice box
 Wood on cockpit seats and floor
 Wooden companionway doors with perspex insert
 Pedestal mounted compass
 Lowerable bathing platform

Engine

Volvo Penta D2-55, 53hp with sail drive
 Operating hours meter
 Tachometer
 Fuel level indicator
 Fuel filter
 Seawater filter

Interior

Three double cabins (four optional)
 Varnished mahogany interior
 Mahogany saloon table
 12V socket at chart table
 Chart table
 Gimballed two burner gas stove with oven
 12V cool box
 110L refrigerator - 12V
 Double stainless steel sink
 Galley stowage for dishes and pots
 Waste bin with lid
 Three fire extinguishers
 Fire blanket
 Three marine heads with manual Jabsco toilets
 Three holding tanks with deck pump out
 Eleven opening hatches
 Ten opening ports
 Blinds and flyscreens on hatches in saloon and forward cabins
 Blinds on portlights
 Manual bilge pump

Sails & Rigging

Double spreader Selden mast
 Headsail designed for furling system
 Conventionally battened mainsail
 Furlex furling system for headsail
 Wind direction indicator
 Hydraulic adjustable backstay

Fresh Water Supply

Water tank 360L
 Water level indicator
 Electric pressure water pump with filter
 Hot and cold cockpit shower

Electrical System

12 V panel with circuit breakers
 Multi function electronic panel
 Voltmeter
 Navigation lights, deck light
 Electric bilge pump
 230V shore power supply
 230V outlets in cabins and galley
 Batteries:
 1 x 88 - Ah battery for starting
 1 x 135 - Ah house battery
 40Ah Battery charger

Steering

Lewmar direct drive steering system
 Twin streamlined balanced rudders
 Rudder stocks with self-alinging bearings
 Emergency tiller
 Twin steering wheels with leather covers

Bavaria Yachts Australia Additional Specification

Electric windlass, Anchor + 50m chain
Rodkick boom vang
Showers with electric sump pumps
Hot Water - 20 litres
UV strip on Genoa
Epoxy barrier and Antifoul
Safety gear and mooring kit
Companionway door cover
Stainless steel gas bottle with certification

North South Yachting Australia Head Office:

T: +61 (0)2 9998 9600

www.northsouthyachting.com.au

Quays Marina, 1856 Pittwater Road

F: +61 (0)2 9979 3244

info@northsouthyachting.com.au

Church Point NSW 2105

All weights and measurements have been calculated on the basis of construction documents and may vary slightly.

Graphs and textual descriptions are in accordance with the information supplied by Bavaria Yachtbau GmbH, Germany, and should serve as a guide.

All details are subject to change without notice. North South Yachting will not be held accountable for changes without the company's control.